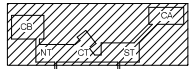
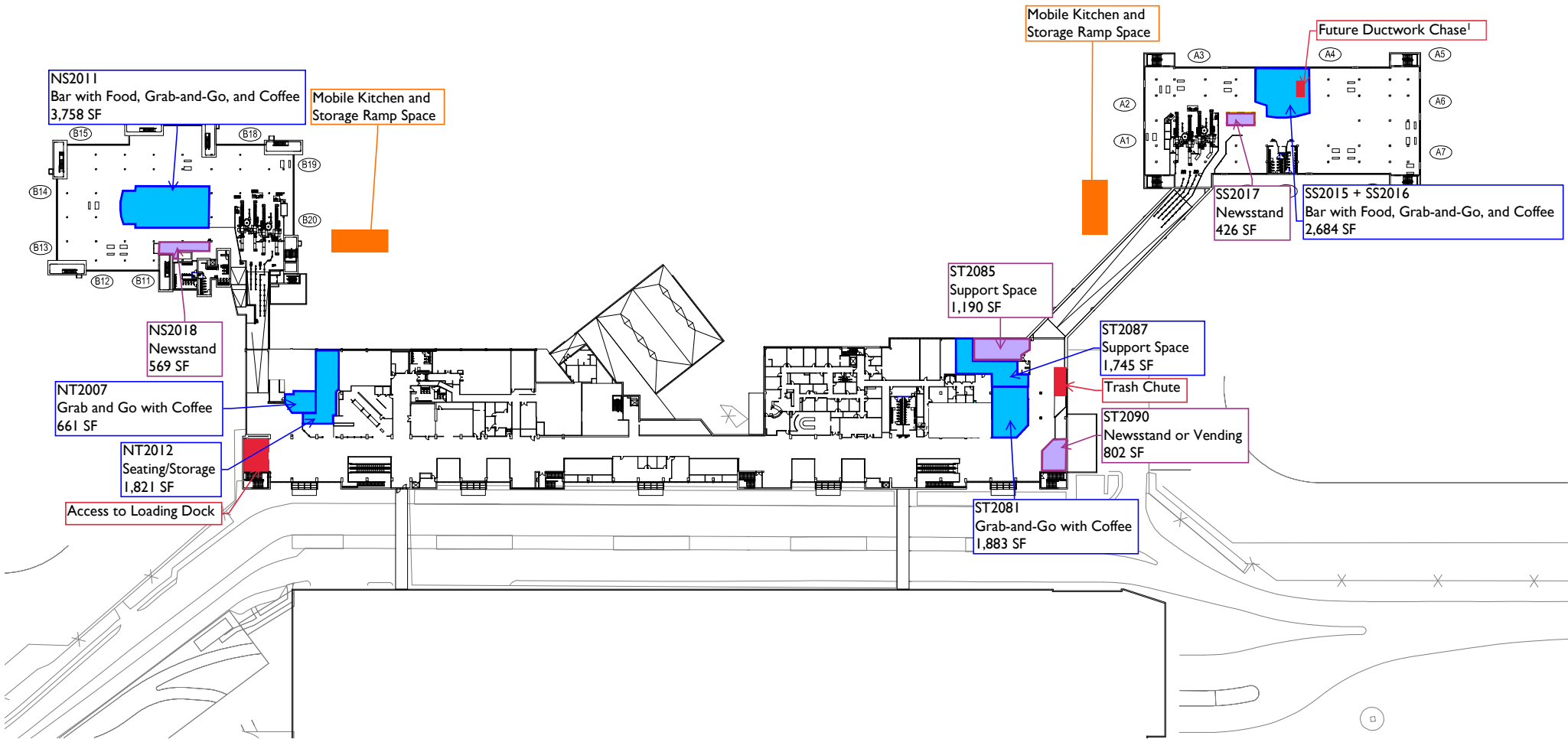

EXHIBIT E - INTERIM CONCESSION PLAN

■ CONCESSION STORAGE & OFFICE
■ FOOD & BEVERAGE
■ RETAIL
■ REVENUE SEATING



1" = 40'-0"

1) The revised Target Construction Impact Date for units SS-2015 and SS-2016, the interim Bar with Food, Grab-and-Go, and Branded Coffee concept, is March 2027 (also the target opening date of the new Central Pavilion). The selected proposer for Package 2 may continue to have access to these units for some period after March 2027, but the space, utilities, and configuration will likely be impacted. The future ductwork chase is expected to be installed starting in March 2027.